

M-Ti SLT Series

Data/Signal Surge Protection Device



Transient Voltage Surge Suppression for standard low speed data (13.5MHz max), communication and signal line protocols. Units provide **protection against Transient Voltages** that exceed the nominal operating voltage of incoming data. Each line is protected against surge current impulses up to 10kA.

The **SLT device** works in series with the communication lines being protected, diverting harmful transient energy while **maintaining a tight clamp** at the peak voltage. Units are designed to operate in a wide temperature range and are configured for simple EIA (Electronic Industries Association) protocols.

The built in floating ground connection allows the device to provide protection at remote locations without creating a ground loop noise problem.

Product Specifications

Max. Surge Current Rating	10kA per Phase
Max Operating Voltage	1.5 - 270 V DC
Response Time	<5 nanoseconds
Series Resistance	5.3 Ohms (nominal)
Clamp Voltage	7.5V - 220V available
Enclosure	Plastic (UL Rated 94 5V)
Max Operating Temperature	-40° to +85°C

- Solid state fail-safe design
- Low shunt capacitance to reduce signal loss
- Performance tested to verify compliance

Dimensions (Diagrams not drawn to scale)

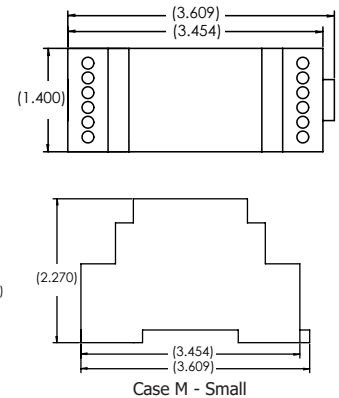
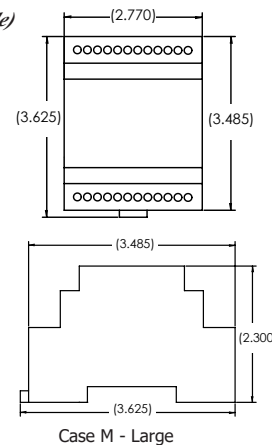
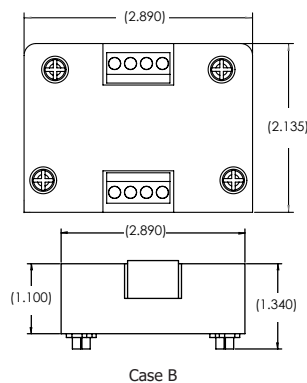
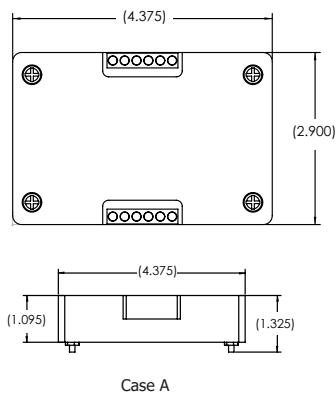

Model Number	Circuit Case	Wires	Shield	Polarity	Protocol	Interface
SLT/	XZ	-XX	X	-X	XXX	-XX
Signal Line Treater	Replace X with A = SAD Arrays C = 5kA (Commercial) I = 10kA (Industrial) S = Solid State	Replace XX with 02 = 2 wires 04 = 4 wires 06 = 6 wires 10 = 10 wires	Replace X with 0 = No Shield S = Shield	Replace X with B = Bipolar Protection U = Unipolar protection	Replace XXX with CL1 = 30V CL2 = 55V DC1 = 95V DC2 = 130V DC3 = 195V DC4 = 18V DC5 = 140V SL1 = 25V SL2 = 10V SL3 = 270V SL4 = 45V SL5 = 50V Other protocols available, contact factory.	Replace XX with TS = Terminal Strip Screw RJ = Mod Jacks Consult factory for additional Interface options.
COMMERCIAL UNITS Utilize MOV & SAD Technology	Replace Z with A = Large Case B = Small Case M = Din Rail Case	Case A has a 10 wire MAX. Case B has a 4 wire MAX. Case M Large has a 10 wire MAX. Case M Small has a 4 wire MAX.				
INDUSTRIAL UNITS Utilize Gas Tube & SAD Technology						

***NOTE:** Installation is accomplished by simply inserting the Protector in series with the communication cable(s) and connecting the grounds as required.

PROTOCOLS: CL = Closed Loop, DC = DC, SL = Signal Line

All product dimensions provided are ± 0.125

800.638.3788
561.845.2007



sales@metertreter.com



www.metertreter.com



1349 South Killian Drive
Lake Park, FL 33403